



LIGHTHOUSE *Senior Living* AT HOPKINS CREEK

Welcome to Lighthouse Senior Living at Hopkins Creek! Our approach to Assisted Living includes a variety of services - from independent living to adaptive personal assistance; from dementia care to short-term stays. This flexibility allows us to continually meet the changing needs of our residents. Lighthouse provides an environment for seniors that is secure and safe, but also fun and exciting. Driven by a vision of excellence and caring, our staff is committed to helping seniors preserve their happiness and dignity in a stimulating and familiar environment.

Our professional staff members are dedicated to upholding the quality of life that seniors desire and expect. We encourage appropriate self-reliance within a supportive community. Our Residents can often be found joyfully interacting with friends, family and neighbors, participating in one of many engaging regularly scheduled resident activities and events, or trekking out to shopping or entertainment destinations - ensuring that living in a senior community doesn't mean giving up freedom and lifestyle.

Lighthouse is located in Middle River, Baltimore County, Maryland, Lighthouse Senior Living embodies the unique flavor of Maryland's Chesapeake Bay and its tributaries. Travel is made easy to and from Lighthouse Senior Living as it is close to the MARC train, I-695, I-95, Route 40, and the Baltimore Washington airport.

Lighthouse Senior Living at Hopkins Creek (*as well as our sister community located in Ellicott City, Howard County*) is managed by The Time Group, a local real estate owner/manager/investor with over 50 years of experience managing communities throughout Metro Baltimore.



Accommodations and Services

LIGHTHOUSE *Senior Living* AT HOPKINS CREEK



BASIC SERVICES

- three healthy and delicious meals per day, served in our elegant dining room
- snacks available in our bistro area
- fun and engaging activities, including restaurant and shopping trips, games, crafts, movie nights, group exercise, musical performances, sing-alongs, and more
- scheduled transportation within a specified travel radius
- weekly personal laundry, including towels and bed linens
- automatic washers and dryers for personal laundry in the common area
- monthly wellness checks and physician visits
- weekly light housekeeping and linen changes
- use of beautiful and relaxing indoor common areas, including private dining room, lounges, lobby, recreational areas, TV room
- beautiful courtyard with walking area in a gorgeous natural setting
- 24 hour on-site staff and emergency call response
- basic cable television and all utilities (*except personal telephone*)
- maintenance of grounds, building and equipment
- routine maintenance of the living area

ADDITIONAL SERVICES (*available for a fee*)

- home health care, including physical and occupational therapies (*when ordered by the physician*)
- medical equipment, oxygen therapy, and personal hygiene items (*when ordered by the physician*)
- medications
- guest meals
- beauty/barber services
- special programs, trips or events outside of the building
- personal telephone
- personal television service other than basic cable

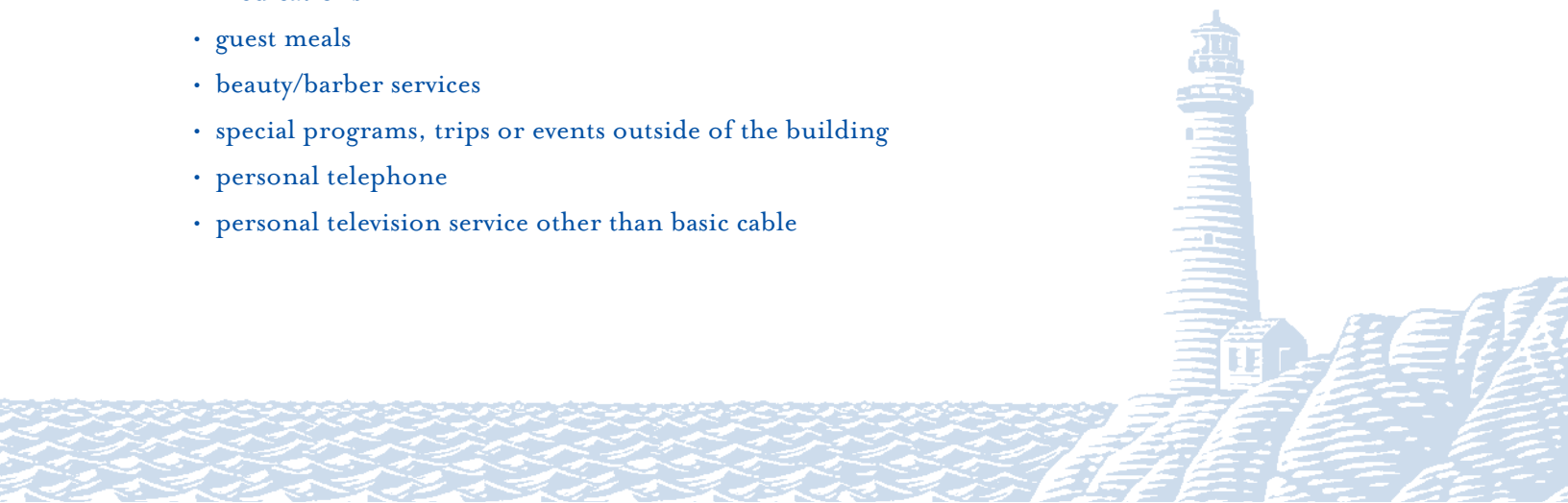

Levels of Care

LIGHTHOUSE *Senior Living* AT HOPKINS CREEK



Seniors may choose Assisted Living simply for the lifestyle it offers. They may no longer wish to be burdened by the maintenance and upkeep of a home and garden and are looking for the freedom Assisted Living offers. Others may have to make the decision to move into Assisted Living because they need some degree of help in managing daily activities and self-care. In addition, the impact of physical and psychosocial disabilities may affect their quality of life, ability to make choices, ability to function and maintain their health and safety.

A potential resident may be totally independent or need additional levels of care. The Lighthouse care staff identifies these care needs during the application and assessment process. We work to accurately identify the scope of services that will be needed to care for the resident.

Potential residents are evaluated and assessed by a Lighthouse Registered Nurse or Licensed Practical Nurse. In addition, an assessment and evaluation of the resident is completed by their personal physician. The data collected from both sources is reviewed then applied to the State of Maryland's Assisted Living Level of Care scoring tool. A level assigned (1, 2, or 3) reflective of the medical illnesses and needs. Additional considerations used in determining the level of care are the need for medication management, risk factors, cognitive impairments, difficult to manage behaviors, daily clinical needs, case management and the level of service coordination needed.

Each Level of Care has been assigned a fee that reflects the intensity of the professional management and clinical care needed to promote the health and safety of the resident in the Assisted Living environment. The Level of Care is periodically reevaluated at the 45-day assessment, after a hospitalization or any other significant change in condition for continued appropriateness. Residents and families will be notified if a change in the level of care is indicated. Monthly fees may increase or decrease following this evaluation.

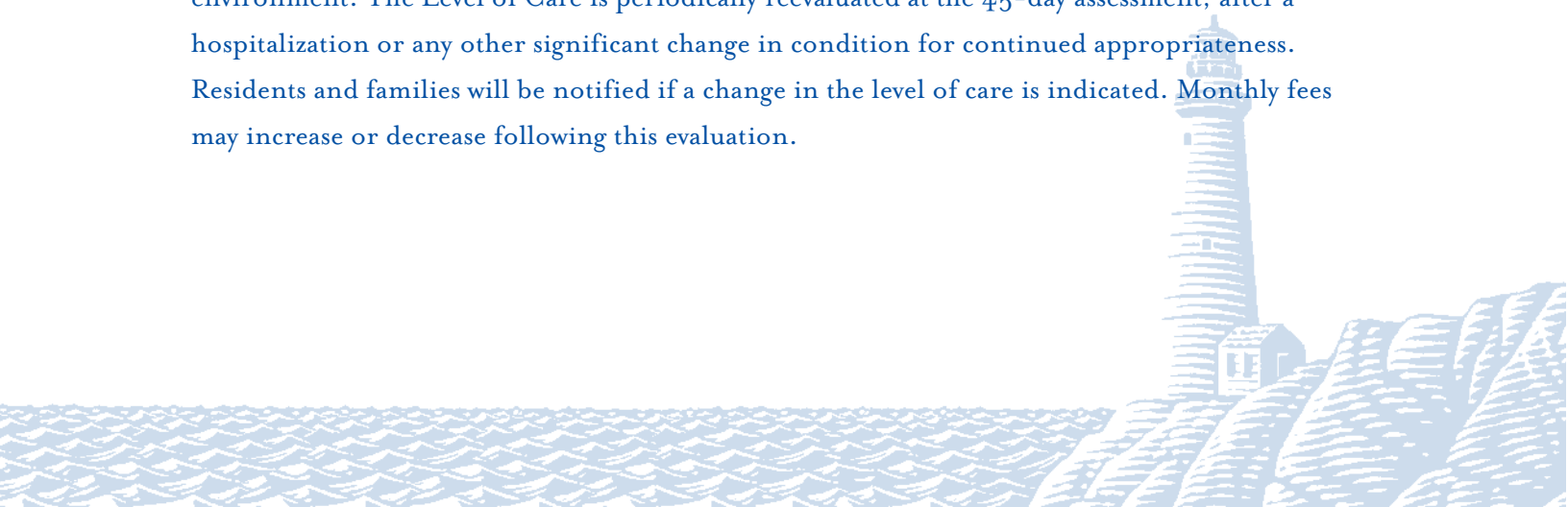

LIGHTHOUSE *Senior Living* AT HOPKINS CREEK



Lighthouse Senior Living at Hopkins Creek features two floor plans to choose from. Each apartment features wall-to-wall carpet, a kitchenette with a full sized refrigerator, ample closet space, window treatments, individually controlled heating/air and easily accessible bathrooms.



Studio

325 sq ft

12 X 15 Living Area

6 X 7 Bath

Kitchenettes in each Unit

All Private

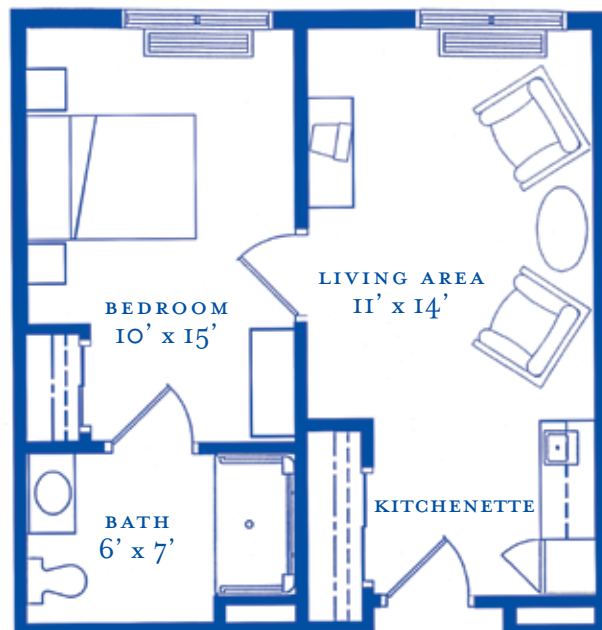

One Bedroom

456 sq ft

11 X 14 Living Area

10 X 15 Bedroom

6 X 7 Bath

Kitchenette in all Units

All Private



The Village

LIGHTHOUSE
Senior Living
AT HOPKINS CREEK



The Village at Lighthouse Senior Living is a specifically designed, secure 'neighborhood' for those residents experiencing memory impairment as a result of Alzheimer's disease and other dementia related illnesses.



A staff specializing in the physical, psychological and emotional aspects of Alzheimer's and related memory impairments focus on stimulating the head, hearts, and hands of these special residents. We customize individual and group programs & engagements to bring residents of the Village a sense of happiness, togetherness, and joy.



We encourage family and friends to visit regularly and participate in these programs with their loved ones to further provide a sense of purpose, pleasure, and belonging.

1813 Old Eastern Ave. • Essex, MD 21221
410-918-0400
www.lighthouseseniorliving.com

